

# DISTRIBUTION PILLARS

ECOPillar - The New Era in Power Distribution



**e** ECO  
PILLAR

[www.transnet.co.nz](http://www.transnet.co.nz)

★ ★ ★  
**NZ**  
MADE



# CONTENTS

---

ABOUT TRANSNET	2
CUSTOMISING YOUR ECOPILLAR	3
ECOPILLAR ACCESSORIES	4
ECOPILLAR TYPE 0 - EP0	6
ECOPILLAR TYPE 1 - EP1	7
ECOPILLAR TYPE 2 - EP2S, EP2	8
ECOPILLAR TYPE 3 - EP3S, EP3, EP3EXT	9
ECOPILLAR TYPE 3.5 - EP3.5, EP3.5EXT	10
ECOPILLAR TYPE 4 - EP4, EP4TALL	11
ECOPILLAR TYPE 6 - EP6, EP6TALL	12
ECOPILLAR TYPE 7 - EP7, EP7LP3	13
ECOPILLAR TYPE 9 - EP9	14
ECOPILLAR TYPE 10 - EP10	14
ECOPILLAR TYPE 11 - EP11S, EP11T	15
TAPPAT LV LINK PILLAR - 2 WAY 600AMP	16
TAPPAT LV LINK PILLAR - 3 WAY 600AMP	17
SUBTERRANEAN UTILITY VAULT 160AMP	18
ALUMINIUM CABINET/PILLAR	19



# ABOUT TRANSNET

## TRANSNET COMPANY OVERVIEW

At TransNet we offer a large range of products to the Electrical Distribution, Transmission, Rail, OEM and Wholesale industry. We have the expertise and knowledge to assist with equipment specification as well as providing hands on service and support in the field.

With three stocking distribution facilities in Australasia, and 24hr contact, TransNet is able to offer local support and fast delivery.

TransNet is one of the largest suppliers to our industry in Australasia, offering the most diverse range of products and support. We have a switchgear workshop, an R&D workshop and a Raychem kitting room on site in our Auckland Head Office and we are well equipped to offer training and support for all our products.

At TransNet we pride ourselves on the ability to react quickly to any situation and have product to you whenever and wherever you need it. Our staff are knowledgeable and happy to help, we have a number of technical specialists in a range of product areas, all ready to assist if and when required.

As the sole New Zealand Distributor of TE Connectivity Energy products including brands such as Raychem, Utilux, AMP and Guro, we have the local and international support and expertise of one of the largest manufacturers in our business. TE Connectivity Energy has a research and development programme second to none, continuously improving existing products, while designing and testing new products to improve network reliability. We are proud to offer an extensive range of quality brands from around the globe for a holistic approach to supply in the electricity industry.



## ENVIRONMENTAL RESPONSIBILITY



At TransNet we take environmental responsibility seriously and as part of our commitment to the environment we have implemented a range of policies and practices to do our part in protecting the environment. We have achieved and maintained ISO 14001 - Environmental Management System certification since 2017, an achievement we're immensely proud of. In addition to this, we have the first and only fully functioning Micro Grid of its kind in New Zealand, right here at our head office. With 150kW of solar generation and a 30kW/130kWh smart storage system, we're able to power our entire operation most of each day.



We're already moving to reduce our impact even more by adding electric vehicles to our fleet and using our solar farm to charge them.

# CUSTOMISING YOUR ECOPILLAR

## FULL CUSTOMISATION AVAILABLE

- Lid details specific to your design requirements
- Component kits based on usage requirements
- Pillar colours & sizes all designed to requirements
- Neutral bar & it's placement adjusted to individual network requirements
- Locks can be fitted



**Multiple Neutral/Earth Bar options & fixing locations available for all ECOpillars**



**Security Torx Screw**



**Security Screw & Padlock**

## FEATURES

- Designed in New Zealand in conjunction with the industry
- 100% Made in New Zealand
- Fully recyclable at end of life



**Security Screw, & Key Lock**

**Customise lid graphics, asset identification, colours etc to suit individual network specific requirements - contact us now!**



# ECOPILLAR ACCESSORIES

The ECOPillar range wouldn't be complete without a range of accessories and hardware created specifically for use with this revolutionary range of distribution pillars.

## PANELS

Made from Fire Retardant plastic, the EPIPD range of panels have a nut moulded into them for secure attachment of the IPD single screw attachment fuse to the panel. The PANELNOHOLES range offers up full customisation.

TransNet Code	Description
EPIPD100ADEP-2	IPD100A DE GREY PVC FUSE HOLDER PANEL 2-WAY
EPIPD100ADEP-3	IPD100A DE GREY PVC FUSE HOLDER PANEL 3-WAY
EPIPD100ADEP-4	IPD100A DE GREY PVC FUSE HOLDER PANEL 4-WAY
EPIPD100ADEP-6	IPD100A DE GREY PVC FUSE HOLDER PANEL 6-WAY
EP2/2SPANELNOHOLES	EP2/2S GREY PVC PANEL - NO FUSE SCREW HOLES
EP3PANELNOHOLES	EP3 GREY PVC PANEL - NO FUSE SCREW HOLES
EP3PANELKITK221CLIPS	EP3 GREY PVC PANEL WITH 4 X K221 CLIPS

For additional panel variations not listed here, contact us.



## PANEL KITS

Made from Fire Retardant plastic, ECOPillar panels have been injection moulded with holes to accommodate standard electrical fittings (Blank panels also available). Panel kits come complete with stainless steel self tapping screws for fastening to pillar.

TransNet Code	Description
EP0PANELKIT	EP0 GREY PVC PANEL DRILLED WITH SCREWS, 2 FUSE
EP2/2SPANELKIT	EP2/2S GREY PVC PANEL DRILLED WITH SCREWS, 5 FUSE
EP3PANELKIT	EP3 GREY PVC PANEL DRILLED WITH SCREWS, 6 FUSE
EP3PANELKITK221CLIPS	EP3 BLANK PANEL KIT WITH CLIPS FITTED FOR 4xK221
EP4BLANKPANELKIT	EP4 BLANK PANEL WITH SCREWS & SPACERS
EP4PANELKIT	EP4 2xGREY PVC PANELS DRILLED WITH SCREWS
EP4K221PANELKIT	EP4 K221 PANEL KIT





# ECOPILLAR ACCESSORIES

## FUSE KITS

A range of fuse kits available for each of our ECOPillar models and these fuse kits can be supplied separately or installed onto the panel prior to shipping.

### PRE-WIRED PANEL KIT EXAMPLES:



Looped Service Fuses



Pre-wired DIN Switch



Pre-wired Fuses



TransNet Code	Description
EPFUSE32AKIT	32A IPD FUSE AND ASSEMBLY TO PANEL
EPFUSE63AKITIPD	63A IPD BRAND FUSE AND ASSEMBLY TO PANEL
EPFUSE100AKIT	100A IPD FUSE AND ASSEMBLY TO PANEL
EPFUSE100AKITIPDCLR	100A CLEAR TOP IPD DUAL ENTRY FUSE AND ASSEMBLY TO PANEL
EPFUSEK221X4	4 X K221 FUSES AND ASSEMBLY TO K221 PANEL



K221 waterproof fuses are perfect for flood prone installations

Contact us for information on having ECOPillars supplied pre-populated and for pre-wired panel capabilities.

## TOOLS

With security being one of the major drivers for changing to ECOPillars, we offer a number of locking solutions which can be easily included in your pillar during manufacturing (conditions apply).

These tools are the ones designed to access all the lock variations we offer.



TransNet Code	Description
ECOPILLARLIDTOOL	ECOPILLAR LEVER LID REMOVAL TOOL
EPTS/SLOCKKEY	STAINLESS STEEL LOCK, KEY - TRIANGULAR
EPTOOL	4 DIFFERENT PILLAR KEYS IN ONE TOOL

# ECOPILLAR ACCESSORIES

## SELF TAPPING SCREWS

Self tapping stainless steel screw designed specifically to hold the panel or fuse carrier in place directly without the need for a nut and washer in behind.



TransNet Code	Description
SS316STBCTRUWP1012	10Gx12MM FUSE MOUNTING SCREW S/S 316 POZIDRIVE
SS316STBCTRUWP1016	10Gx16MM PANEL MOUNTING SCREW S/S 316 POZIDRIVE

## ECOPILLAR TYPE 0 - EP0

Incorporating a slimline low visibility profile, EP0 is ideal for use in low demand installations like small homes, utility buildings, street light circuits, electronic advertising signs and illuminated bus shelters.

### FEATURES

- 3 stud tinned neutral bar
- Flame retardant gear panel
- 2 captured Torx40 screws for fastening
- Unique serial number

### CAPABILITIES

- Up to two 32, 63 or 100amp standard fuse carriers
- 1 x K221 watertight fuse carrier

### DIMENSIONS

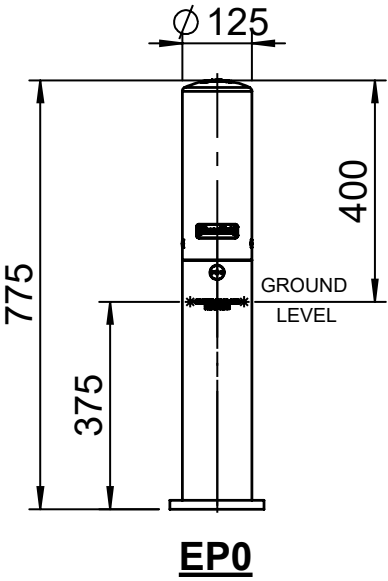

Fuse carriers attached using self tapping screws



K221 Waterproof fuse carrier for flood prone installations





# ECOPILLAR TYPE 1 - EP1

A touch safe and watertight solution. Uses the industry approved TransNet fastener free locking lid system, eliminating fasteners and requiring one simple tool for access. Can accommodate up to three K199 fuse carriers.

## DIMENSIONS

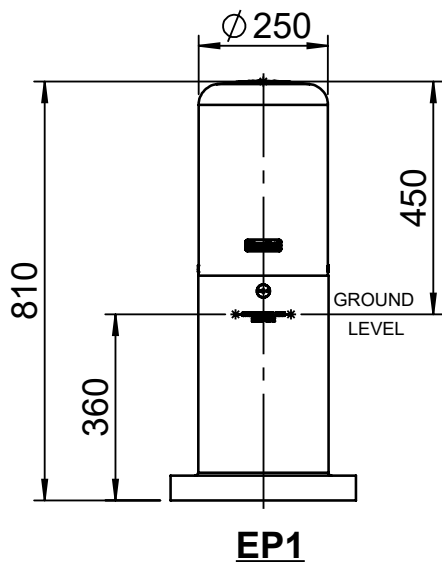

## TYPE 1 COMPONENT OPTIONS



7-1201146-7 Gelport  
watertight neutral bar for  
Al/Cu cable 4-150mm<sup>2</sup>  
(16-240mm<sup>2</sup> available)  
ANSI C119.1,2002



Guro MM5 Underground  
Resin Breach Joint Kits,  
suit Al/Cu cables of 3 or  
4 core 50-240mm<sup>2</sup> with  
tails of 6-120mm<sup>2</sup>



Removable mounting rack  
accommodates 3xK221,  
4x65U & 1x4 way Gelport



Fastener free locking  
system ensures  
maximum safety for  
workers & public alike



65U watertight 30amp  
fuse holder accepts Al/Cu  
conductor 2.5-16mm<sup>2</sup>



2-1200171-6 Gelcap Pilot  
Wire Connection Block  
accepts Al/Cu conductors  
from 2.5-70mm<sup>2</sup>



K221 watertight 100amp  
IPC fuse holder accepts  
Al/Cu conductors  
of 6-50mm<sup>2</sup>



ECOPILLARLIDTOOL Tool  
for opening EP1 style  
ECOPillar with fastener  
free locking system

# ECOPILLAR TYPE 2 - EP2S, EP2

The compact and unobtrusive design keeps visual impact to a minimum whilst allowing for a generous number of service fuses.

## FEATURES

- 5 stud tinned neutral bar
- Flame retardant gear panels
- 2 captured Torx40 screws for fastening
- Unique serial number

## CAPABILITIES

- EP2S Up to 5 service fuses
- EP2 Up to 10 service fuses  
Up to 4 K221 watertight fuse carriers  
1x160amp DIN00 disconnecter with up to 2 service fuses



## DIMENSIONS

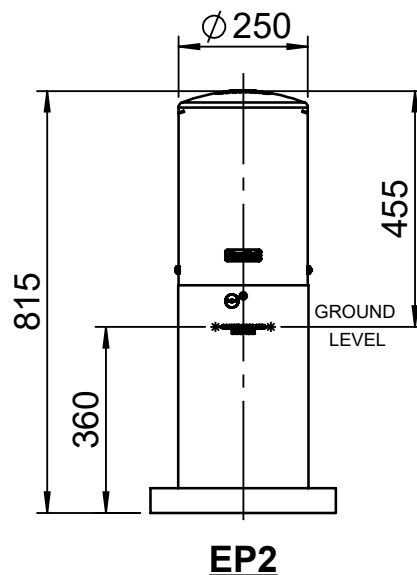
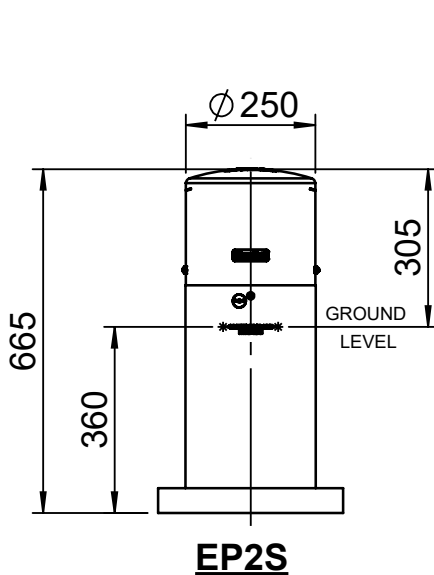

EP2S - Rack and Panel



EP2 - Rack and Panel

# ECOPILLAR TYPE 3 – EP3S, EP3, EP3EXT

With an increased footprint the EP3 range offers more internal space to get the job done while maintaining the aesthetically pleasing rounded profile.

## FEATURES

- 5 stud tinned neutral bar (other N/E bar option available)
- 2 captured Torx40 screws for fastening
- Flame retardant gear panel
- Unique serial number

## CAPABILITIES

- EP3S Up to 7 service fuses.
- EP3 Up to 14 service fuses or switchgear up to 250amp DIN1 disconnectors.
- EP3EXT Up to 14 service fuses and switchgear up to 250amp DIN1 disconnectors, but offers an additional 200mm in height making it perfect for flood prone areas.

\*Additional combinations possible



**EP3S - Rack and Panel**



**EP3 - Rack and Panel**



## DIMENSIONS

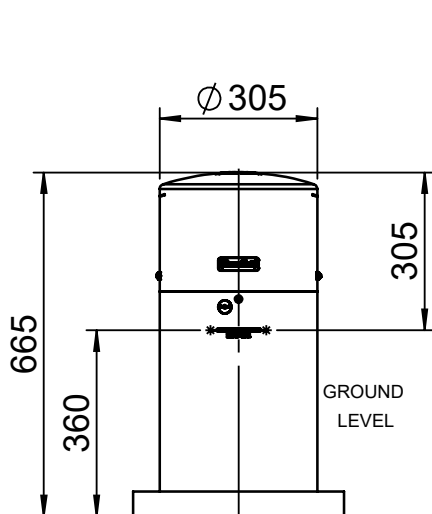

**EP3S**

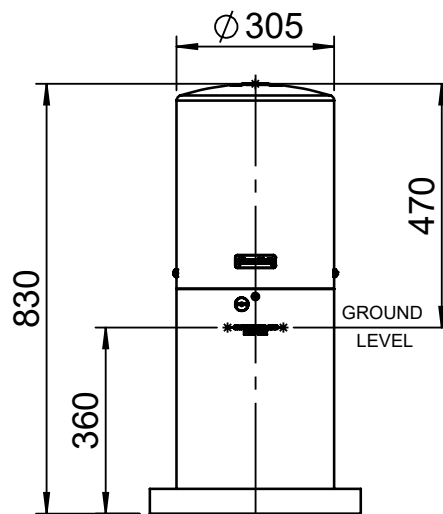

**EP3**

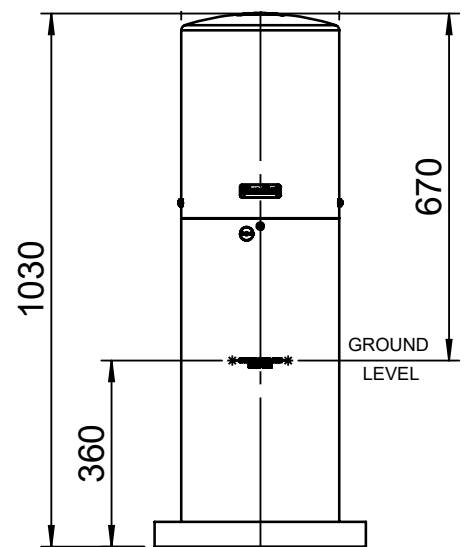

**EP3EXT**

# ECOPILLAR TYPE 3.5 - EP3.5, EP3.5EXT

The big brother to the EP3, the EP3.5 was designed to provide more room inside for larger cables, crossing of cables and generally more room to work. With the same capacity as the EP3, this unit is versatile and can accommodate many different combinations of fuse carriers and disconnect switches.

## FEATURES

- 5 stud tinned neutral bar
- Flame retardant gear panels
- 2 captured Torx40 screws for fastening
- Unique serial number

## CAPABILITIES

- Up to 14 standard fuse carriers
- 1 x 160amp DIN00 disconnecter with up to 3 standard fuse carriers
- 2 x 160amp DIN00 disconnectors
- 1 x 250amp DIN1 disconnecter with up to 4 standard fuse carriers

\*Additional combinations possible



## DIMENSIONS

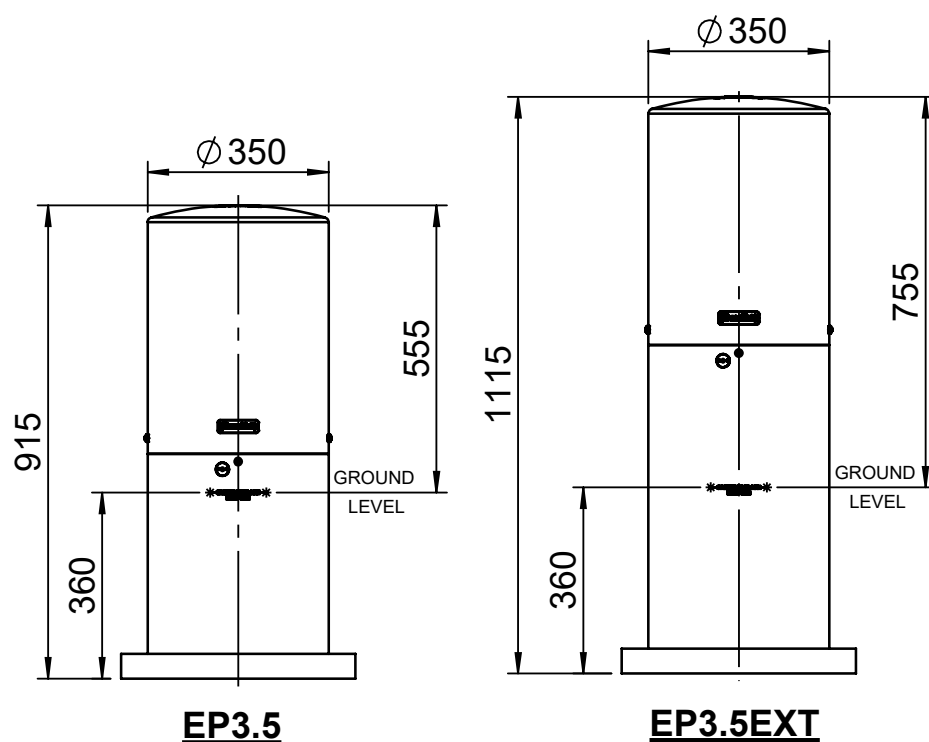



# ECOPILLAR TYPE 4 - EP4, EP4TALL, EP4EXTTALL

The EP4 is designed to house larger 400 / 630amp Horizontal Disconnect Switches along with many combinations of smaller disconnects and fuses. When more space is required, the EP4TALL has got you covered.

## FEATURES

- EP4 has 5 stud tinned neutral/earth bar  
EP4TALL has 8 stud tinned neutral/earth bar
- 3 captured Torx40 screws for fastening
- Unique serial number
- Range of optional flame retardant gear panels
- Removable/rotatable rack (EP4TALL only) allows the 'free space' to be swapped from back to front of pillar

## CAPABILITIES

- Range of Horizontal Disconnectors & Service fuses



EP4 rack and panel configurations are easily customised



## DIMENSIONS

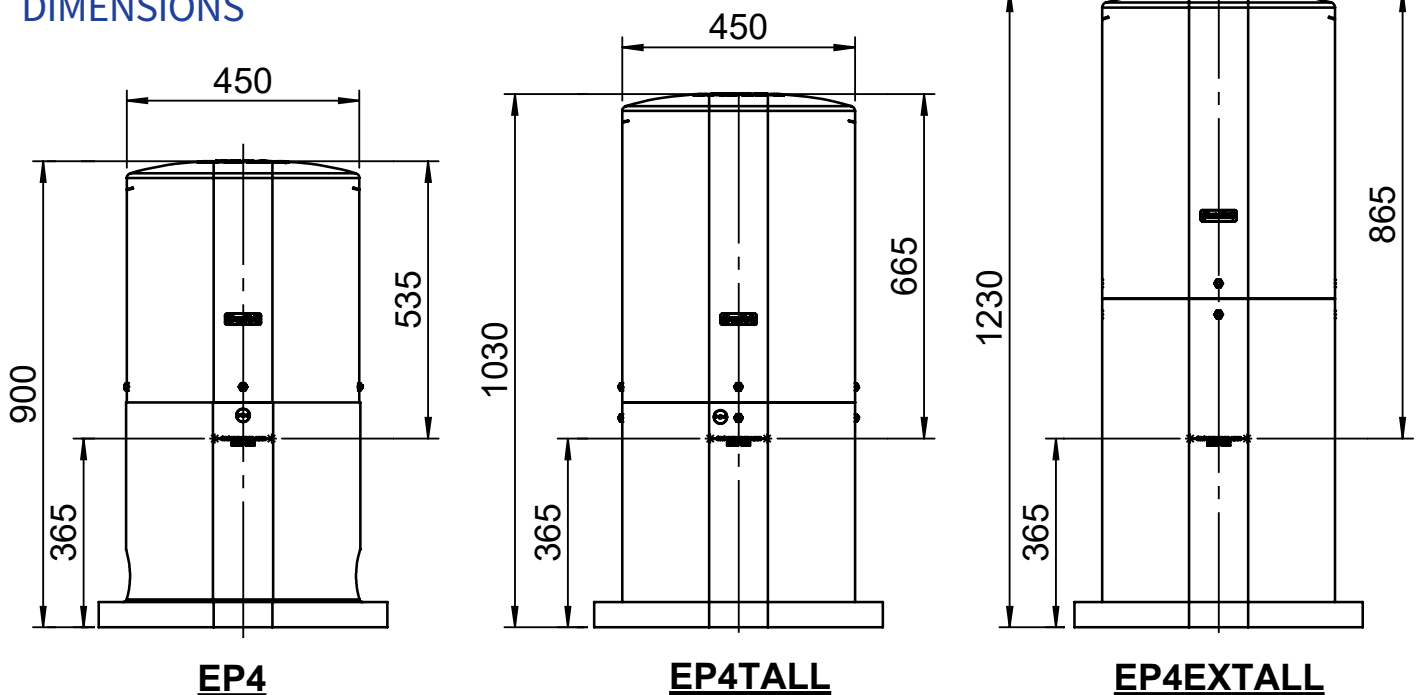

# ECOPILLAR TYPE 6 - EP6, EP6TALL

Designed to maximise the safety of field staff, the EP6 has no exposed live parts when used with Gelports, more room to work inside and the added benefit of a removable rack so all cables can be made off without the rack hindering the workspace.

The EP6TALL offers additional height for a double rack making it perfect for network link and junction pillar hardware as well as being able to house standard service fuses and disconnect switches.

## FEATURES

- 8 stud tinned Neutral/Earth bar with rubber shroud
- Can accommodate fully submersible touch safe Gelport connectors
- Fully removable rack
- 2 captured Torx40 screws for fastening
- Unique serial number



## CAPABILITIES

EP6	Up to 10 x standard fuse carriers
	Up to 3 x 160amp Disconnectors
EP6TALL	4 x 5way panels allow for up to 20 standard fuse carriers
	Mix of Disconnector switch sizes
	Mix of Disconnector switches and standard fuse carriers

\*Additional combinations possible

## DIMENSIONS

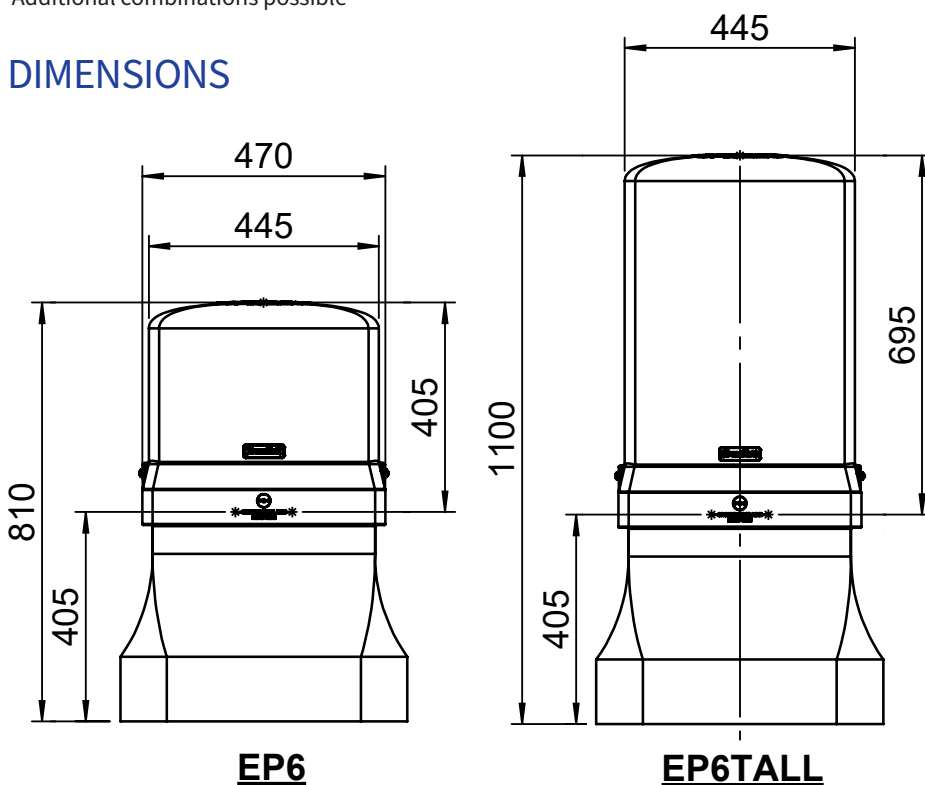

**EP6 - Rack and Panel, showing Gelport connectors**



**EP6TALL - Rack and Panel**

# ECOPILLAR TYPE 7 - EP7, EP7LP3

The versatile ECOPillar EP7 is robust and safe, cabinet style pillar with either a blank rack or including the specially designed internally fitted busbars ready to be populated with vertical disconnect switches. Comes standard with a 6 stud, M12 tinned Neutral/Earth bar.

## FEATURES & BENEFITS

- Hot dip galvanised steel base
- Fully removable front cover and lid for uninterrupted easy access
- Two part rack safely encloses wiring from components and fittings
- Captured torx40 screws for fastening lid and front cover
- These pillars can be used as link, junction or service pillar
- Base structure is galvanised steel (concrete mount also available)
- Vented for ambient cooling
- EP7LP3 includes Encapsulated Copper busbar, ensuring no bare live parts
- Danger labels available for unused busbar positions in EP7LP3

\*Note: this unit is sold empty, any switchgear or accessories required will be charged accordingly.



## DIMENSIONS

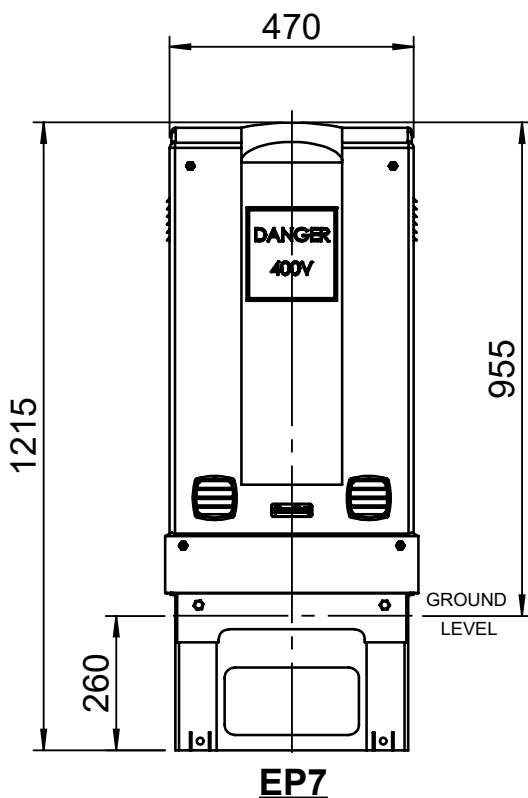

### EP7

**EP7 - Blank internal rack designed to accommodate a range of switchgear**



### EP7LP3

**EP7LP3 - Encapsulated Busbar system designed for added safety and protection for workers**



# ECOPILLAR TYPE 9 - EP9

The EP9 has a compact installation footprint and flat sides making it perfect for locating close to fences. The contoured design with no sharp edges offers pleasing looks and robust functionality.

## FEATURES

- 7 way flame retardant fuse panel
- Removable fuse rack
- 8 stud M8 tinned Neutral/Earth bar
- Can be fixed to a concrete base
- 2 X captured Torx40 bolts
- Unique serial number



## CAPABILITIES

- Up to 7 standard fuse carriers

## DIMENSIONS

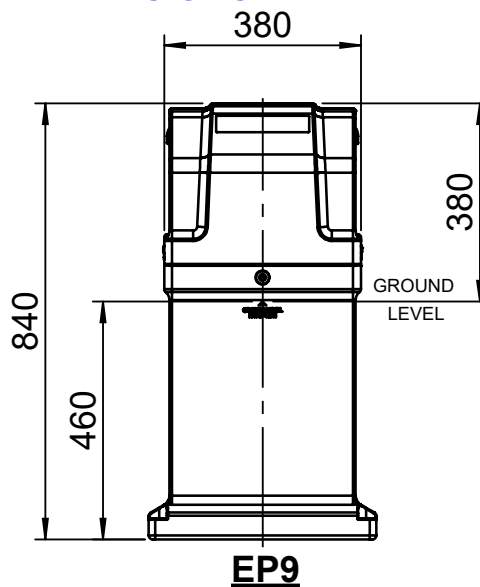

# ECOPILLAR TYPE 10 - EP10

The EP10 has a compact installation footprint making it perfect for tight spaces. The round design offers strength and smooth lines. This unit is designed by people in the industry for people in the industry.

## FEATURES

- Flame retardant fuse panels
- 5 stud tinned Neutral/Earth bar with safety cover
- 2 captured Torx40 screws for fastening
- Unique serial number

## CAPABILITIES

- Up to 4 standard fuse carriers
- 1 x 160amp disconnect



## DIMENSIONS

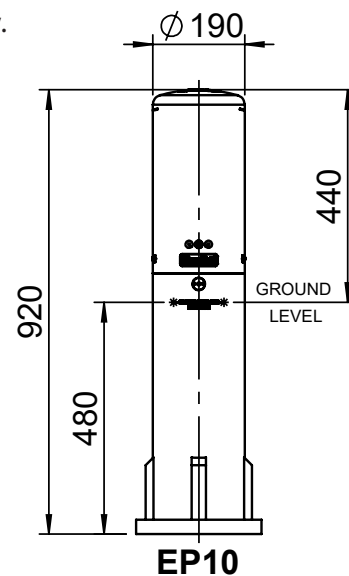



# ECOPILLAR TYPE 11 - EP11S, EP11T

EP11 - The ultimate distribution pillar. Designed specifically for LV reticulation in NZ conditions. Addressing issues with existing designs as well as increasing electrical and environmental demands.

## FEATURES & BENEFITS

- Interchangeable pre-wired or predrilled racks support various fuse setups with spacing for heat dissipation, reducing fire risk
- Two part lid creates clear demarcation between Network (mains) and Service connections & restricts accessibility
- Easily upgrade from short to tall pillar (increasing fuse capacity) without changing the base
- Captive fixing screws accessible from front of pillar
- Hex ribbing for added strength with less material
- Open base area with removable kick plate for ease of placement & working with larger cables
- Neutral/Earth bar with multiple bolt sizes
- Anti-tamper spring lock & 2 captive screws for security & safety
- Two piece vents prevent tampering, improve safety & offer added ventilation for air flow and heat dissipation
- Installation up to 2.5hrs faster than other pillars
- Designed and made in NZ in collaboration with local asset owners & contractors



## DIMENSIONS

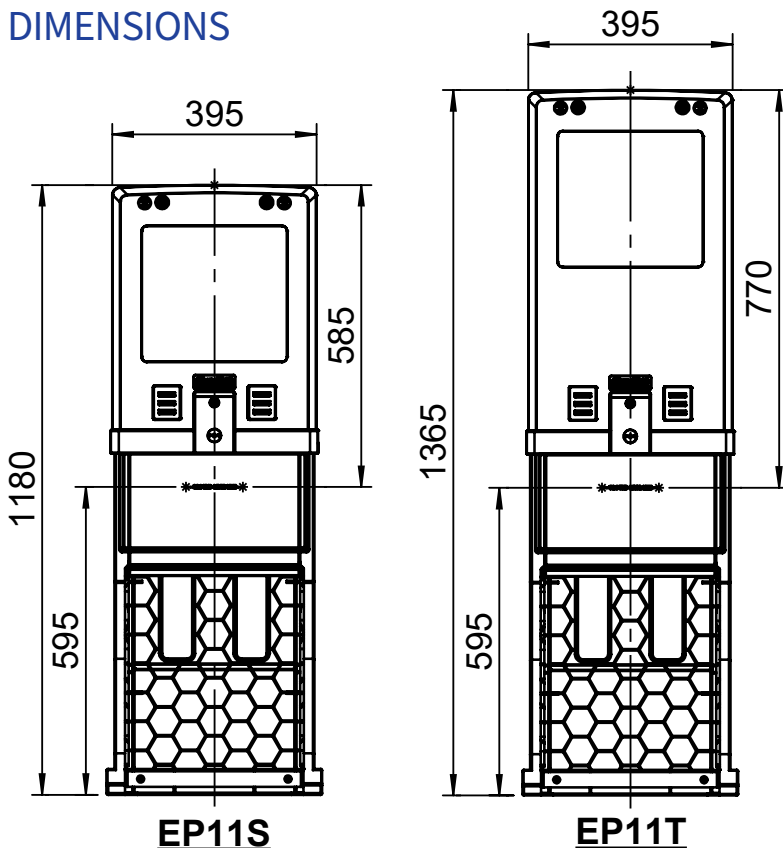

**Examples of prewired racks for both EP11S and EP11T. Talk to us about your requirements.**

# TAPPAT LV LINK PILLAR - 2 WAY 600AMP

Allows greater flexibility when isolating, paralleling, back feeding or sectionalising LV cables. Perfect for placement at intermittent locations along an LV cable run as an open point between transformers or every second boundary giving the network the ability to restore supply to customers along a faulty cable run except the customer with which the fault is located. This concept would also apply to planned outages.

Minimal disruption during routine maintenance and replacement projects will become the norm as each pillar is back fed via the Tappat linking system, to the boundary either side of the job.

Increased safety through reduced live jointing requirements.



## FEATURES & BENEFITS

- Tinned Brass connections eliminate the possibility of corrosion
- 185mm<sup>2</sup> to 300mm<sup>2</sup> mains, up to 50mm<sup>2</sup> service connections
- Tested to 600 AMPS
- GelPort – main neutral (16mm<sup>2</sup>–185mm<sup>2</sup> x 1port & 185–300mm<sup>2</sup> x 2ports)
- Up to 6 service fuses can also be accommodated (2 x 3 phase or 6 x 1 phase, 32/63/100amp or street light fusing)
- UV Stable fully recyclable plastic pillar (TE-LINK-2-3-G-EP6)
- Range of locking systems available
- Low profile/unobtrusive design
- Functional switching capacity reduces customer outage minutes during fault conditions



## DIMENSIONS

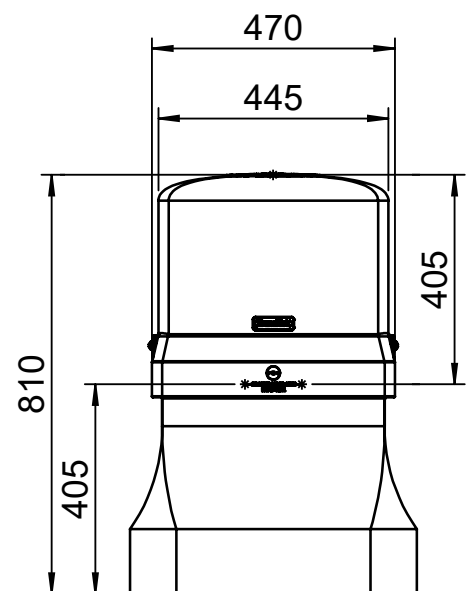

**EP6**

TransNet Code	Description
TE-LINK-2-3-G-EP6	TE TAPPAT LINK 2 WAY SWITCH WITH 1 X 3PORT GELPORT NEUTRAL CONNECTION, HOUSED IN LOW PROFILE EP6 PILLAR

# TAPPAT LV LINK PILLAR - 3 WAY 600AMP

This pillar gives the network the ability to parallel or isolate LV mains cables and can also serve as a demarcation point for industrial customers. It would be well placed along a low voltage cable run where a tee off is required to supply a side street.

## FEATURES & BENEFITS

- 3 x linked mains connections from 185mm<sup>2</sup> up to 300mm<sup>2</sup>, accommodates Al or Cu round or sector cables
- Staggered main connections run vertically to minimise cable crossings
- Phases independently separated and insulated
- Easier, faster and safer to install and operate
- Fits perfectly inside the ECOPillar EP6TALL
- Fully insulated and touch safe system
- True 3way switching to energise or isolate LV mains, or to supply multiple LV feeders in parallel
- Ability to include up to 6 additional service connections per phase, 1x70mm<sup>2</sup> and 2x50mm<sup>2</sup> per side of the unit
- Tinned brass connections eliminate possibility of corrosion
- Proven and reliable dovetail connection; no specialised tooling required
- Make / Break tested – 100x100amps; then 10x400amps
- Tested to 600amps



## DIMENSIONS

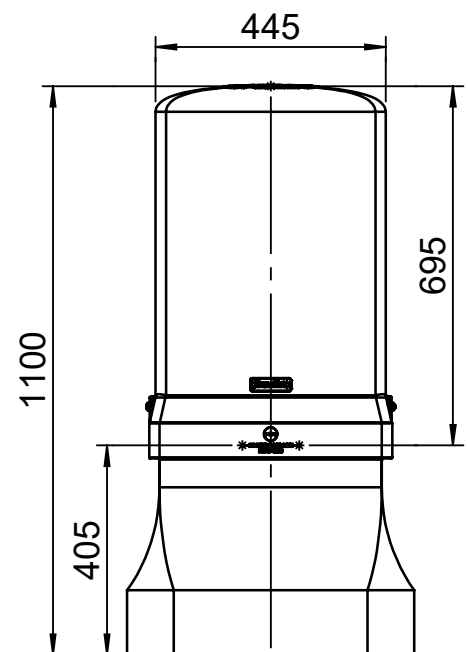

**EP6TALL**

TransNet Code	Description
TE-LINK-3-3-G-EP6	TE TAPPAT LINK 3 WAY SWITCH HOUSED IN UV STABLE EP6TALL ECOPILLAR

# SUBTERRANEAN UTILITY VAULT 160AMP

This unit offers a solution for commercial sites and places where 100 amp solutions are not sufficient. The 160 amp disconnect gives customers the same functionality as an above-ground solution without the clutter.

The subterranean nature of this solution is perfect for pedestrian accessways and areas with a high volume of foot traffic. It also offers an aesthetically pleasing solution to reduce visual impact on the surrounding landscape. Housed in an IP68 hinged electrical enclosure, the 160 amp disconnect works exactly as it would above ground. The waterproof enclosure has glanded cable entry ports and is housed in a diving bell for added protection from moisture ingress.

The pit itself has a small footprint, is able to be installed in light traffic areas (footpaths and driveways) and can be parked on or driven over. It can be locked with a stainless steel key lock if required. And a Class C or D Cover is available for this unit.

## FEATURES

- Fully lockable
- Diving Bell lid bolted in place
- Sits flush with the ground
- 160A, 3Ø fuse disconnect fitted
- Double layer protection from moisture - an IP68 electrical enclosure and an additional Diving Bell enclosure

## SPECIFICATIONS

- Enclosure qualifications
- Meets requirements of AS3996-2006 -Class B for load to 80kN (Class C or D cover set also available)
  - Meets requirements of AS/NZS 3661.1 for slip resistance



## DIMENSIONS

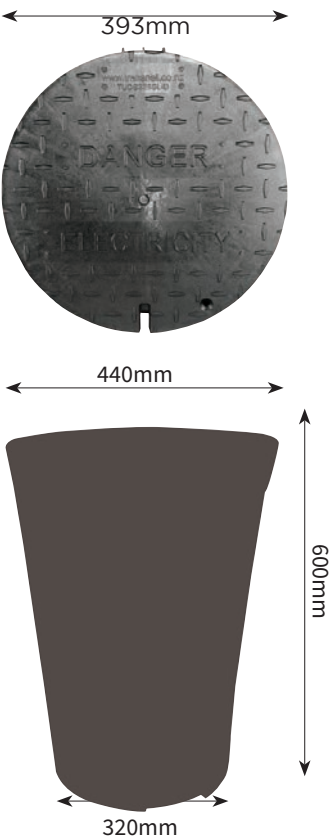

Dive Bell Lid



IP68 Electrical Enclosure

TransNet Code	Description
TUDSUV160A	TUDS SUBTERRANEAN UTILITY VAULT 160AMP, WITH DIVING BELL & ENCLOSURE



# ALUMINIUM CABINET/PILLAR

These robust industry standard cabinets are made from 2.5mm marine grade alloy powdercoated with a rippled industry standard green coating. The range includes; 300mm, 500mm and 700mm wide with others available on request. The hinged door makes for easy access to authorised persons while the secure locking mechanisms can be included to ensure public safety and no unauthorised entry.

The removable lower front sill allows for easy access to the cable installation area.

The hot dip galvanised underground base is included.

## FULLY CUSTOMISABLE

- Perfect for use as Link, Customer service & Metering pillars
- Can be installed freestanding or recessed into walls/fences
- Custom sizes available (some conditions may apply)
- Lock options are available
- Quality materials - Hot dipped galvanised base, Aluminium or Stainless steel (special order only) powder coated body
- Custom branding including warning labels, network asset numbers & identification labels can be installed prior to delivery
- Hinged cabinet doors, earthed to cabinet body for safety - this can be done in accordance with network requirements
- Tinned Copper Busbars, Switchgear & blank cover panels available
- All inclusions must be confirmed at time of order

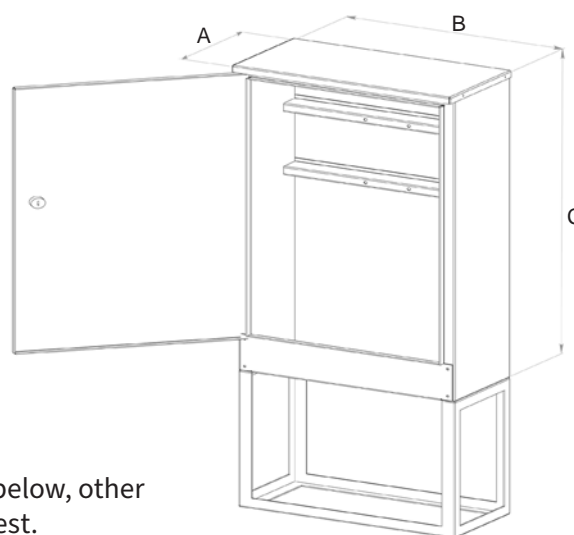

## STANDARD RANGE

Stocked sizes listed in table below, other pillar sizes available on request.

TransNet Code	Description	Dimensions (mm)
EPA300	ALUMINIUM CABINET, GALV BASE, FORMICA & N/E BAR	300(b) x 870(c) x 265(a)
EPA500	ALUMINIUM CABINET, 4 WAY C/W GALV BASE	500(b) x 880(c) x 330(a)
EPA700	ALUMINIUM CABINET, 6 WAY C/W GALV BASE	700(b) x 880(c) x 330(a)
EPABBIP	EPA500 & EPA700 BUSBAR INSULATED PANEL, FOR UNUSED POSITIONS	100 x 500 x 10
EPA500-BBRP	EPA500 BUSBAR REPLACEMENT PANEL (Blank PVC)	390 x 500 x 10
EPA700-BBRP	EPA700 BUSBAR REPLACEMENT PANEL (Blank PVC)	590 x 500 x 10

---

---



EDITION: 2

CAT # ECO Pillar 09/25

TransNet NZ Ltd has made every reasonable effort to ensure the accuracy of this information and it is to the best of our knowledge correct and reliable. Under no circumstances does this constitute an assurance of any particular quality or performance and users should independently evaluate the suitability of products for their desired application. All information in this publication including pricing, drawings, illustrations, images and graphic designs are reflections of our current understanding. TransNet NZ Ltd reserves the right to make any adjustment to this information at any time. Our liability for the products outlined in this publication is set forth in our standard terms and conditions of trade. In case of any potential ambiguities or questions, please contact us for clarification.



**TRANSNET NEW ZEALAND LTD**

ISO 14001 CERTIFIED  
CARBON CONSCIOUS COMPANY

sales@transnet.co.nz | +64 9 274 3340

**AUCKLAND**  
78 Cryers Road  
East Tamaki  
Auckland  
NEW ZEALAND  
Ph 0800 442 182

PO Box 39 383  
Howick, Auckland  
NEW ZEALAND

**WELLINGTON**  
10 Petone Ave  
Petone  
Wellington  
NEW ZEALAND  
Ph 04 576 2530

PO Box 39 383  
Howick, Auckland  
NEW ZEALAND

**NUKU'ALOFA**  
Lakalakaimonu Multi Utility Complex  
Taufa'ahau Road  
Poutaha, Nuku'alofa  
TONGA  
Ph +67 627 939  
Fax +67 627 976  
PO Box 2932  
Nukualofa  
TONGA

TRANSNET TONGA

